

## CFD-50 Ice-lined Refrigerator Operation and Maintenance



**CAUTION:** Read and follow instructions carefully to ensure proper refrigerator performance and safe vaccine storage



**TECHNICAL SUPPORT CONTACT:**

NAME:

PHONE:

### OPERATION

#### Commissioning

- Install refrigerator in a dry and well ventilated area
- Place refrigerator on a level surface and at least 10cm from the wall
- Fill refrigerator with clean drinking water before use – DO NOT OVERFILL

FILL  
INSTRUCTIONS

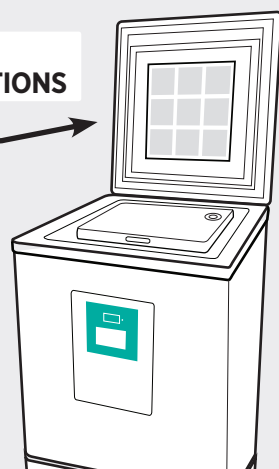

#### Daily Routine

- Keep the door closed and latched — open only when required
- Check the storage temperature to ensure it is within +2°C to +8°C

#### Vaccine Storage

- ONLY use refrigerator when thermometer indicates +2°C to +8°C
- Store payload anywhere inside refrigerator's compartment; all internal surfaces of refrigerator are within +2°C to +8°C during normal operation, but do ensure sufficient air gaps between payload for cold air circulation.

### MAINTENANCE

#### At the beginning of each month:

- Wipe down condensation inside the vaccine chamber
- Remove any surrounding objects around the refrigerator that might obstruct airflow
- Clean external condenser
- Clean front and back ventilation covers
- Clean and check door gaskets for cracks; replace if necessary

#### Every year (Technician):

- Check water level

**AUCMA**